

All dimensions are in millimeters unless otherwise stated.
This drawing to be checked against all other relevant drawings and any dimensions are to be check on site.
Do not scale from drawing.

DRAWING TITLE
**No.21 HIGH STREET SOUTH -
PROPOSED WALL INFILL**

SCALE DATE
1:10 @ A3 02/08/2023

PROJECT TITLE
**REINSTATEMENT OF THE
HISTORIC SHOPFRONTS,
WINDOWS AND
ARCHITECTURAL FEATURES
AND REPAIRS TO THE
HISTORIC FABRIC**

PROJECT ADDRESS
**21-23 High Street South
Dunstable
LU6 3SA**

DRAWING NO.
CA/1276/23/08

REVISION

SCHEDULE/NOTES

CLIENT:
Capital Developments (London) LTD
Aylmer Drive
Stanmore
Middlesex
HA7 3EG

**Conception Architects
Studio**
Gothic House
Barker Gate
Nottingham
NG1 1JU

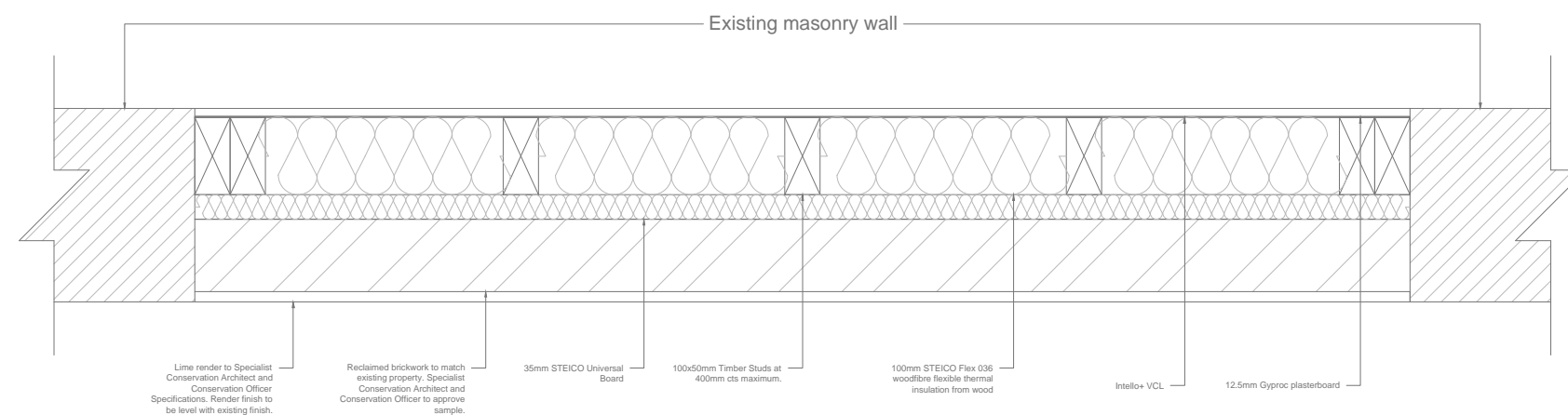

No.21 High Street South Proposed Wall Infill